

BMB & A JSC.

Together We Build The Better Future

Cambodia Project Reference

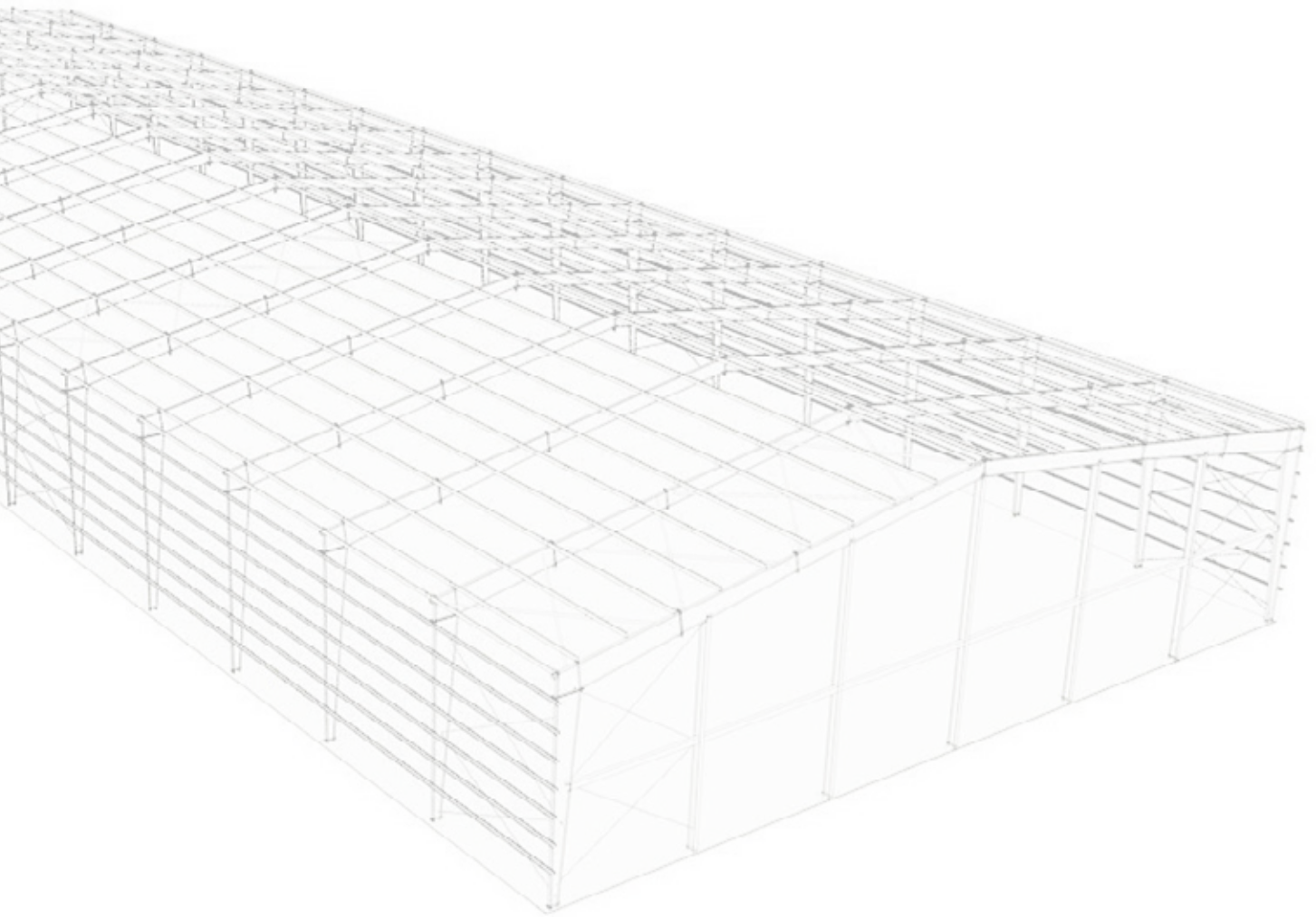

PARADISE CASINO

Area : 10.750 sq meters

Location : Sihanouk Ville





KINGMAKER

Project Type : Garment Factory

Area : 16.000 sq meters

Location : Bavet



SIEM RIEP AIRPORT TERMINAL

Project Type : Extension

Area : 5.000 sq meters

Location : Siem Reap



Project Type : Warehouse

Area : 10.000 sq meters

Location : Bavet



DKSH

Project Type : Warehouse Extension

Area : 5.253 sq meters

Location : Phnom Penh



FERTILIZER

Project Type : Warehouse

Area : 6.000 sq meters

Location : Kompong Speu



COAL SHED

Project Type : Warehouse

Area : 12.654 sq meters

Location : Steung Hav Sez



MONG RETHY GROUP

Project Type : Brick factory

Area : 30.000 sq meters

Location : Sihanoukville



PRIMALLIS

Project Type : Rice Mill

Area : 50.000 sq meters

Location : Kompong Speu



MAKRO SIEM REAP

Area : 20.000 sq meters

Location : Siem Reap



Project Type : Garment Factory

Area : 12.000 sq meters

Location : Kandal



LCH

Project Type : Factory
Area : 6.400 sq meters
Location : PPSEZ, Phnom Penh



HUGO CASINO

Project Type : Casino & Hotel
Area : 4.142 sq meters
Location : Sihanouk Ville



NATIONAL BANK OF CAMBODIA

Area : 10.000 sq meters



LYP GRUOP

Project Type : Garment Factory

Area : 120.000 sq meters





INTRODUCTION

BMB Steel specializes in design, manufacture, supply and erection of pre - engineered steel building and steel structure for projects such as: shipyard building; international airport; exhibition center; hydroelectric plant; warehouse; factory; workshop; showroom; cold - storage; steel mill tower and many kinds of steel structure buildings.

