

BMB & A JSC

TOGETHER WE BUILD THE BETTER FUTURE



KINGPOST
STEEL STRUCTURE
HIGH-RISE STEEL BUILDING
PRE - ENGINEERED STEEL BUILDING







Index

Introduction	4
Equipment manufacturing	6
Design / Fabrication/ Erection	8
Quality control & Planning	10
Erection team & Safety regulation	11
Module of Pre-engineered Steel Building	12
Standard Building	14
Main Frame Types	15
Structure Details	16
Standard Accessories	18
Various special component	19
Kingpost structure	20
Insulations	21
Panel profiles	22
Decking - Standard panel color - Sundry items	23
Typical projects	24
Japanese projects in Vietnam	38
Projects in Vietnam	42
Projects in Myanmar	64
Projects in Thailand	78
Projects type in Cambodia	82
Projects in Singapore, Australia & Indonesia	92
Projects in Philippines.....	94
Projects with repeated customers	98
Contractors & Customers	107
Testimonials	108
Social activities	110

INTRODUCTION

BMB Steel is known for the quality of its products and services and for its attention to safety and we are determined to maintain our high standards through continuous improvement of processes and procedures. Our organization and all the plants are ISO 9001 certified BMB Steel is structured into two main divisions as following

- (1) Pre Engineered Steel Building
- (2) Structural Steel

BMB Steel has done over two thousand buildings and all kind steel structure projects such as warehouse, factory, showroom, steel mill, fertilized factory, shipyard shop, hydro power plant, bridge, communication tower, kingpost of high-rised building, ... etc just for ten years since 2004.

BMB Steel 's commitment is high quality, timely delivery and satisfied customers. We always have relationship with our customers.

BMB Steel , we would be delighted to hear from you and look forward to serving you.





**Total Area of
4 Factories**
90,000 m²
Capacity
60,000 tons of steel/
year
(Steel structure/
Sheeting)

Equipment manufacturing



1. Automatic Welding & Strengthening lines



2. Surface preparation of steel by Blasting machine



3. Panel Rolling machine



4. Downspout machine



5. Deforming Purlin Machine



7. CNC & Hydraulic Cutting



6. Deforming Seam Machine



8. Trim Machine

Offering full package of Design / Fabrication/ Erection

DESIGN

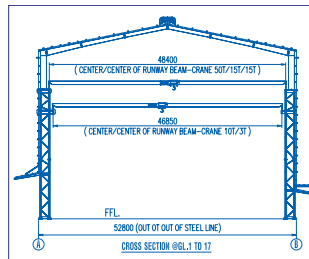

Concept Design



Proposal Drawing



Making Straight



Manual Welding



Automatic Welding



Grinding



ND Testing



Surface Preparation



Completion



Installation of Panel & Accessories



Frame Erection

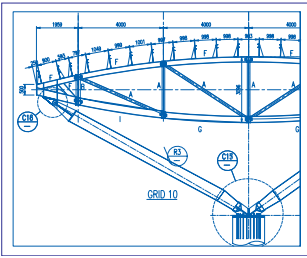

Approval & Shop Drawing Design

FABRICATION



Raw Material Test



Hydraulic Cutting Machine



CNC & Hydraulic Cutting



Tensile Test



Painting



Testing



Packing

ERECTION



Setting up Anchor Bolt



Delivery

Quality control & Planning



QC & Planning



Carefully checking all detail during fabrication



Making straight



Welding inspection at factory



Painting inspection



Erection team & Safety regulation



PPE



Checking blood pressure



Safe net - Line life



Boom lift



Safety ladder for moving



Module of Pre-engineered Steel Building

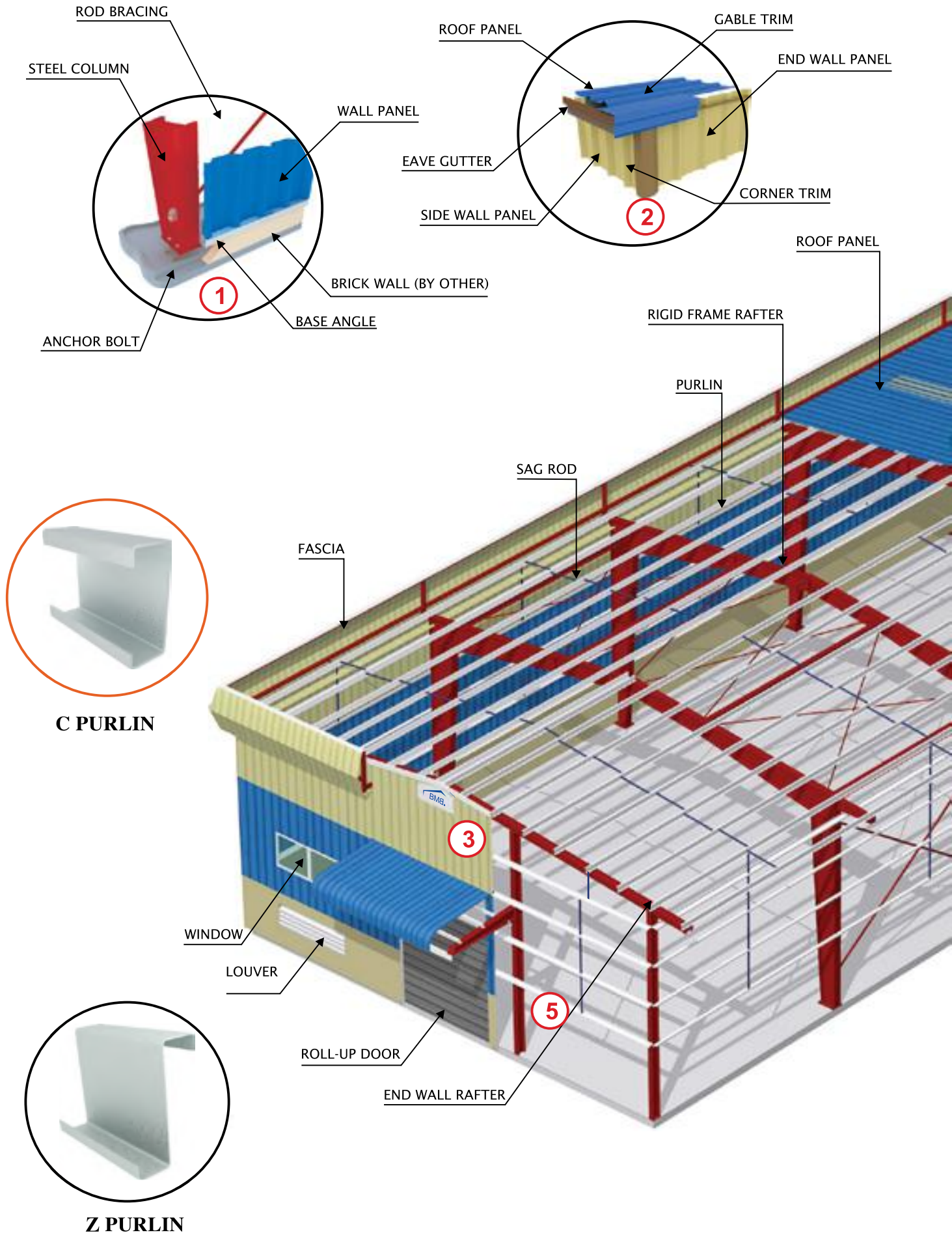

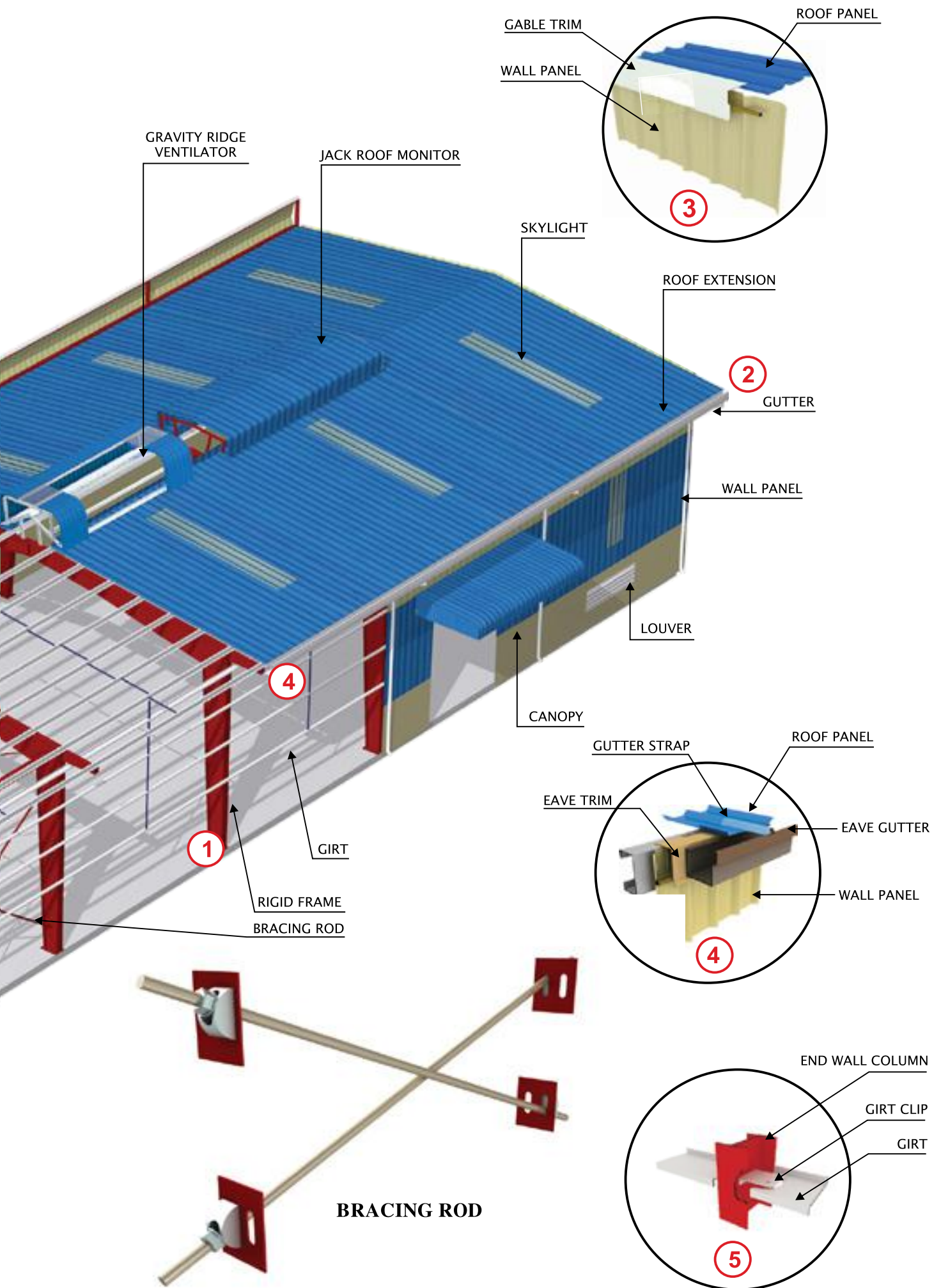

Standard Building

STANDARD CODE APPLIED



(MBMA) Low Rise Building Systems Manual
Metal Building Manufacturer's Association, Inc.



(AISC) Manual of Steel Construction, Allowable
Stress Design American Institute of Steel
Construction, Inc.



(AWS) Structural Welding Code-Steel ANSI/
AWS, D1.1-2008, American Welding Society.



(AISI) Cold Formed Steel Design Manual
American Iron and Steel Institute.

SOFTWARE APPLIED

BMB Steel applies the latest version of Legal license to design structural, engineering, shop drawing and fabrication planing and erection of all steel structures.



Software from CSI and BENTLY, USA



- ▶ Earthquake load, snow load, collateral loads or any other must be specified in quotation.
Loads are designed in accordance with the latest American codes: MBMA, AISC, ASD, AISI, AWS, ASTM.

Design Load: unless otherwise specified the pre-engineered buildings are designed for the following standard loads:

- ▶ Live load on roof: 0.57 KN/m^2
- ▶ Live load on roof: 0.30 KN/m^2
- ▶ Wind load speed: 110/130/140 ... Km/h

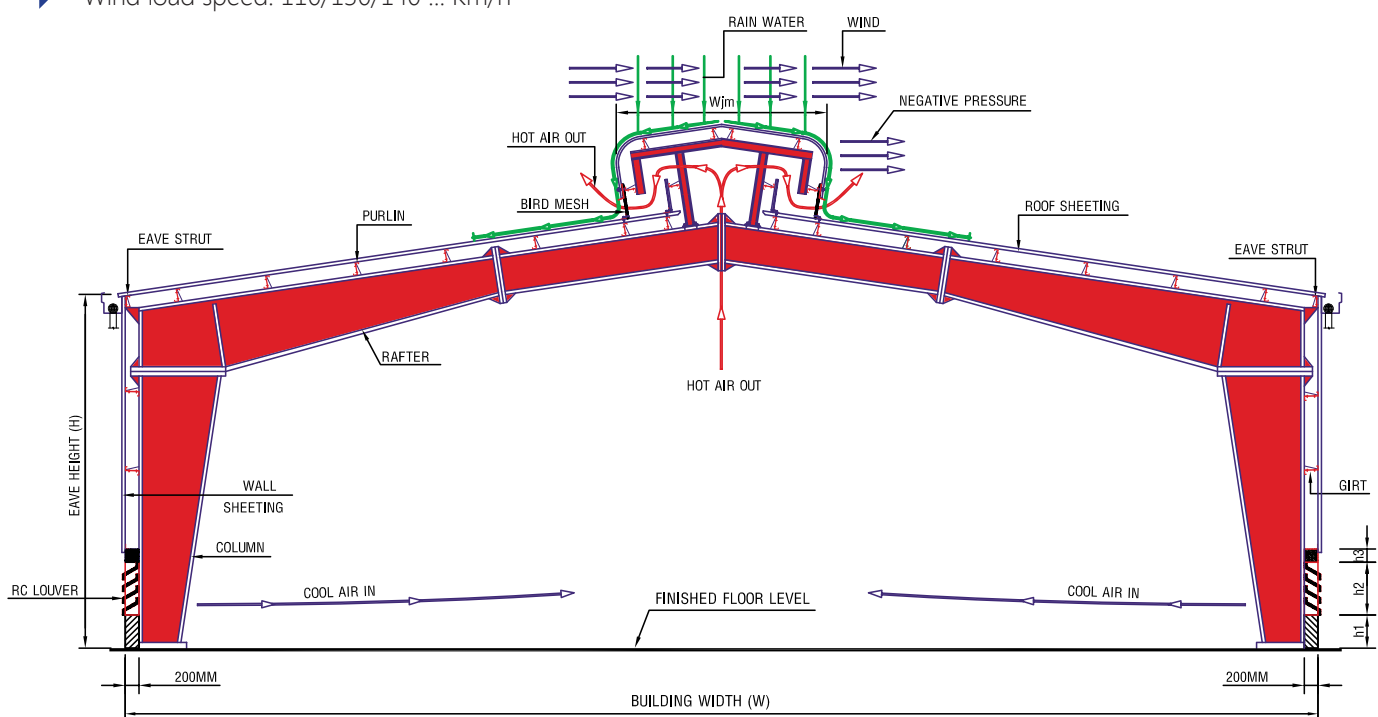

TYPICAL CROSS SECTION

Main Frame Types

BMB Steel recommends the most economical building width ranges:

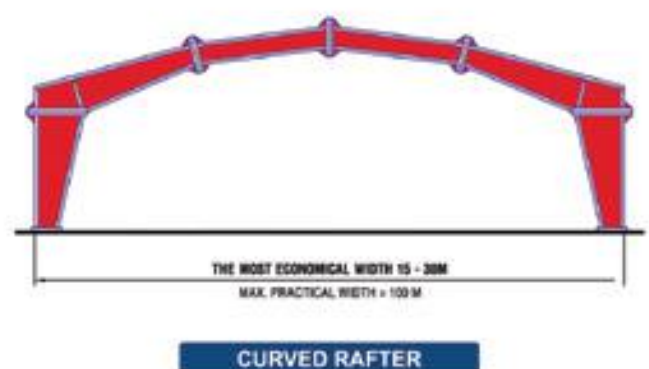
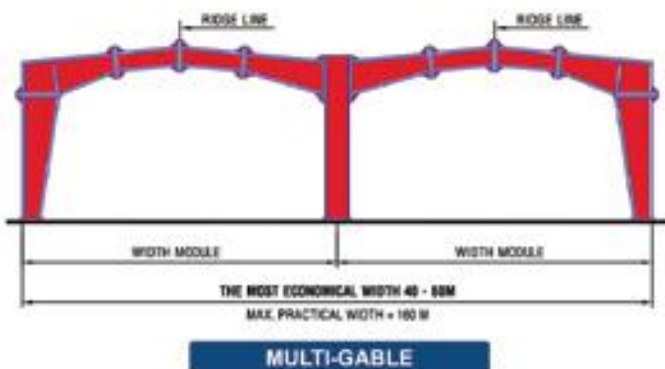
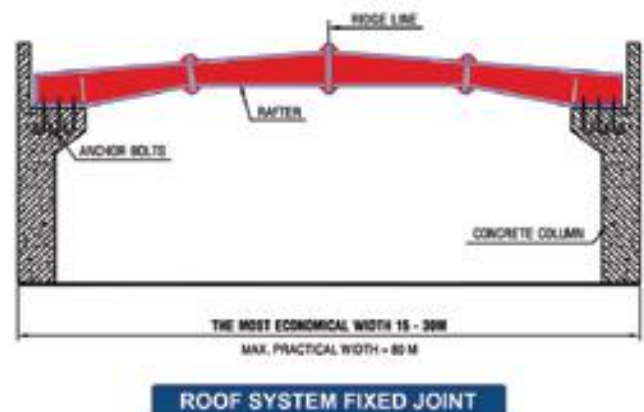
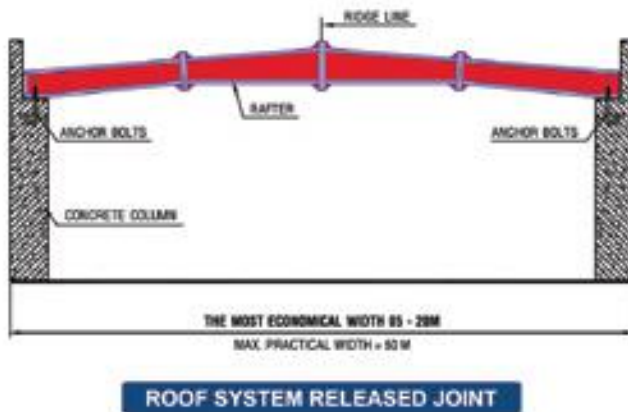
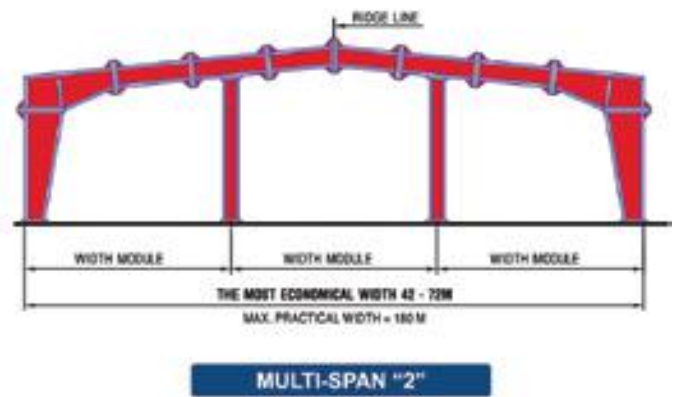
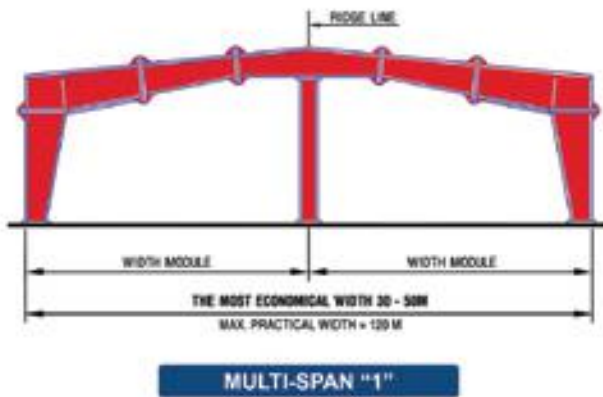
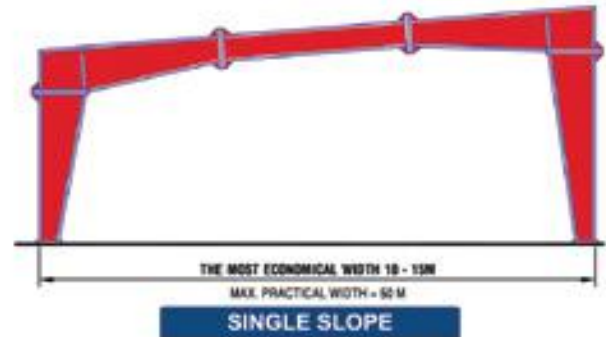
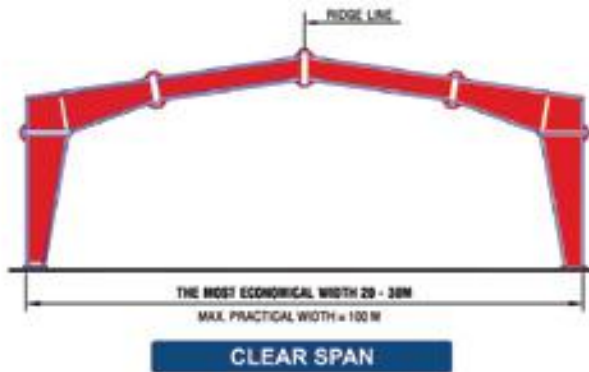

Structure Details

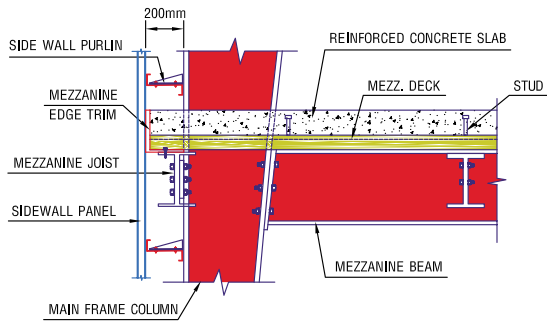

MEZZ. BEAM AND COLUMN

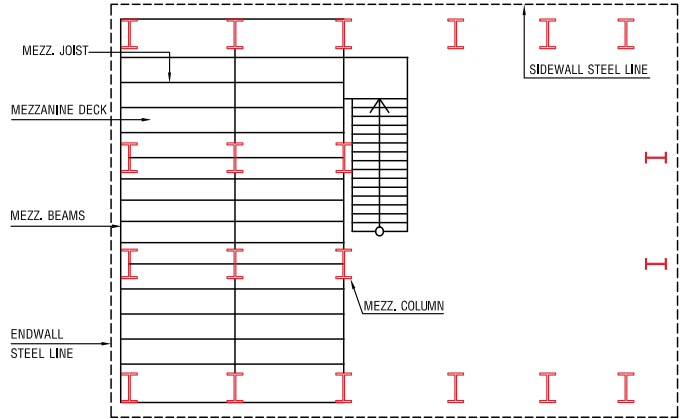

MEZZANINE PLAN

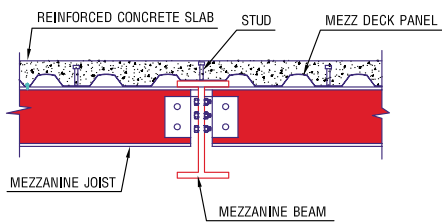

JOIST AND BEAM

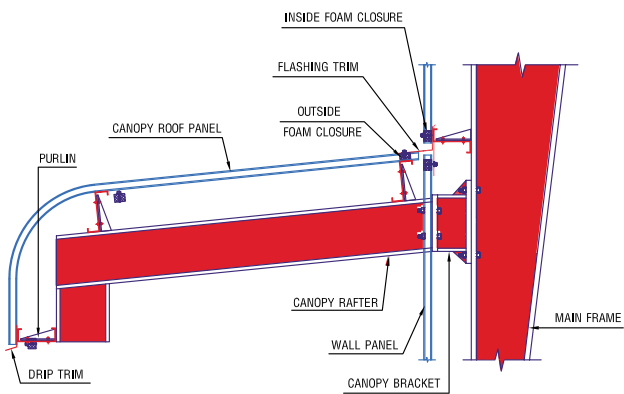

CURVED EAVE CANOPY

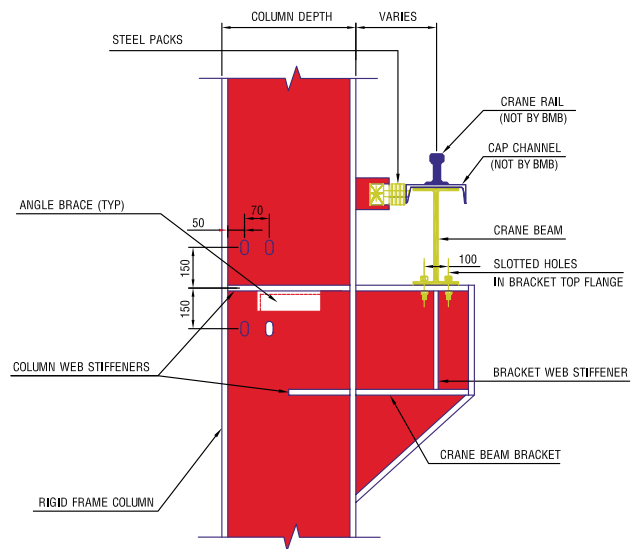

DETAIL - 1: CRANE BEAM AND BRACKET

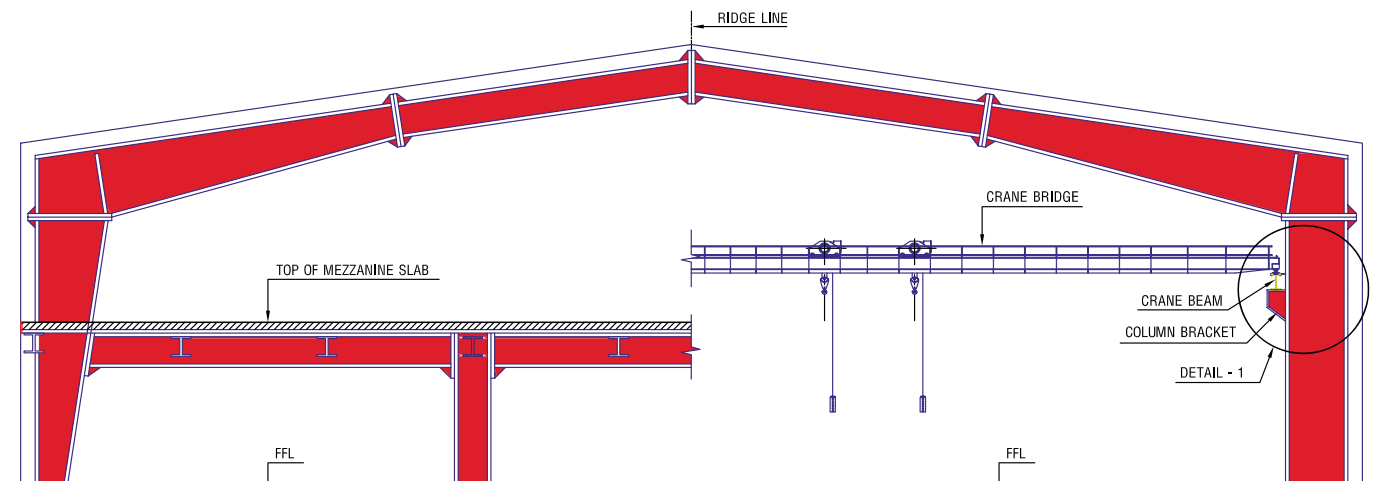

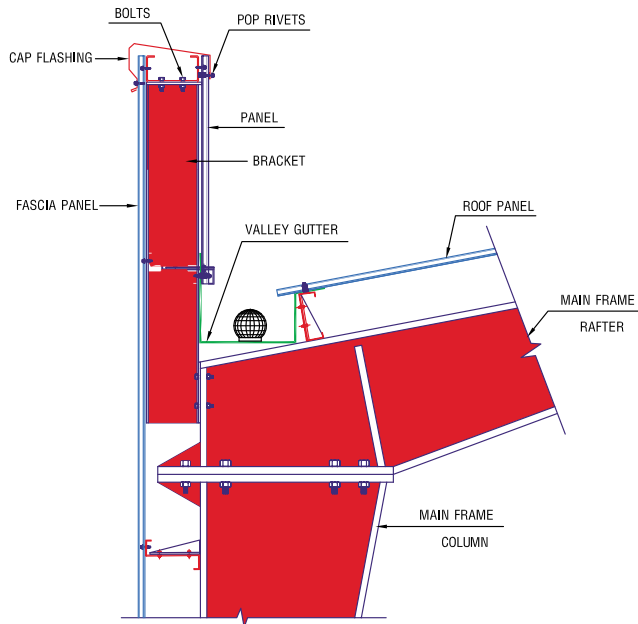

PARAPET FASCIA

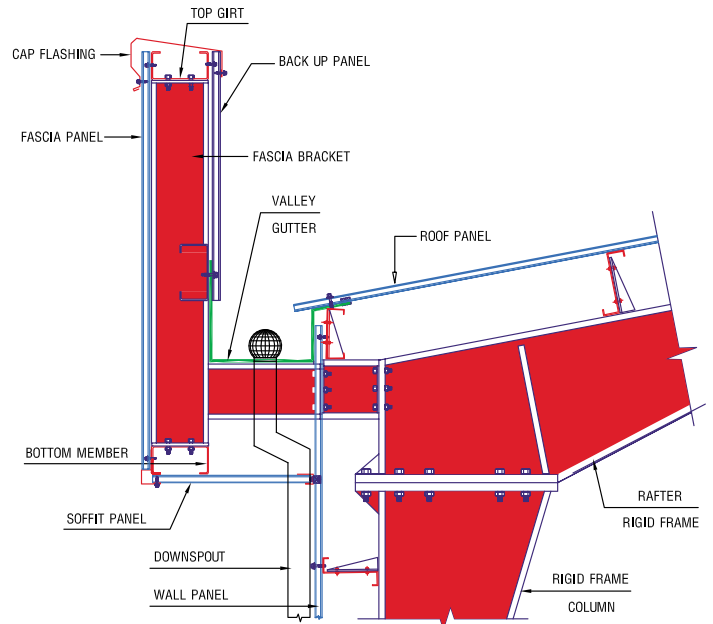

VERTICAL FASCIA

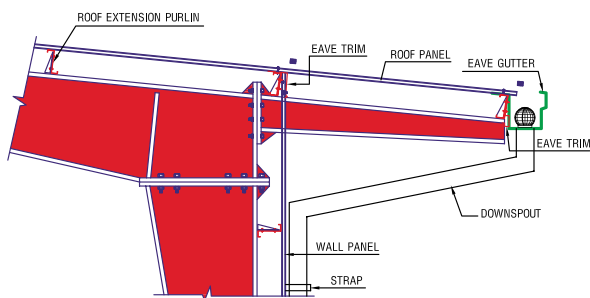

SIDE WALL ROOF EXTENSION

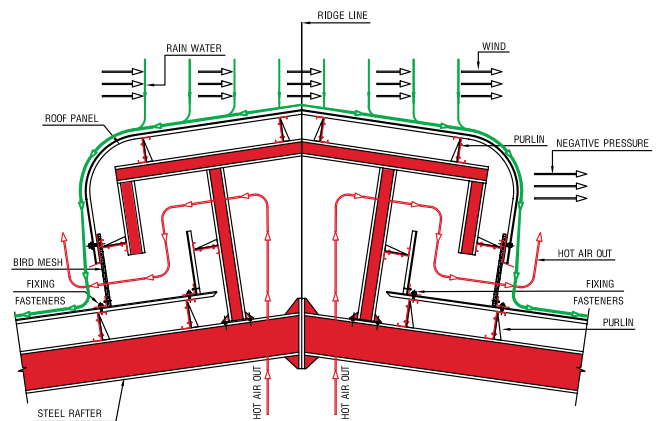

JACK ROOF MONITOR

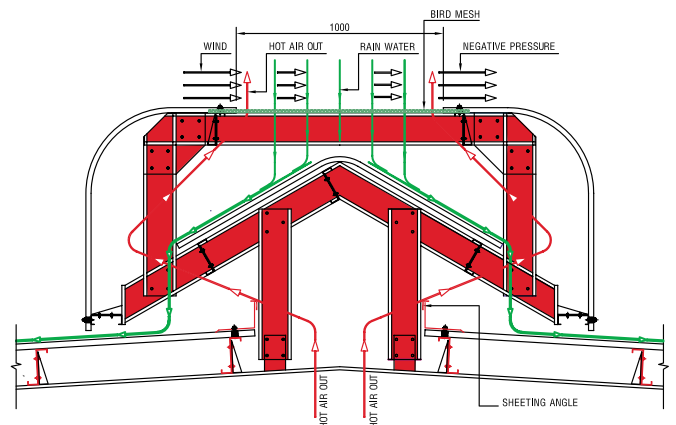
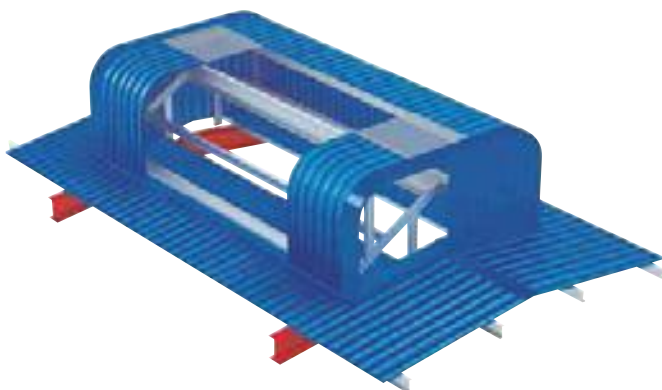

RIDGE VENTILATOR

Standard Accessories



Sliding door



Roller door



Louver & Pilot window



Roof skylight



Wall skylight



Cat ladder



Pipe rack & Staircase



Celling support



Hanging support



Cobveyor structure



Runway of crane



Composite beam



Composite decking



Checker plate



Steel grating



Expanded metal



Struss jack beam



Hangar door



Partition



Decking

Various special component



Bridge Beam



Space roof structure



Lace Column



Transfer struss 4mH



King post



Composite Column



Tower Column



Open Web structure

Kingpost structure



Butt joint by SAW

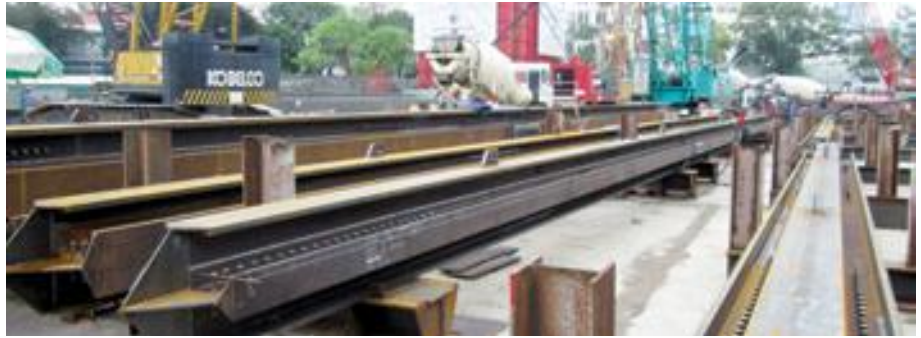

Assembly area



Kingpost fabrication



Table method of KP



Shear stud connection



Plunging KP



Bolt connection



Temporary cable after Segment installation

Insulations

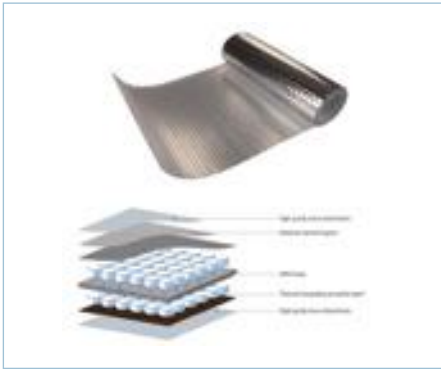

AIR BUBBLE FOIL

With one/ two aluminum foil side(s). The products are fiber-free and manufactured of pure aluminum foil bonded to polyethylene bubble sheeting. It is a safe, non-toxic fiber, easy-to-install, maintenance-free and not.



GLASSWOOL

It maintains the heat insulating and preserving function and has very good shock reducing and sound absorbing property. Glass wool felt with aluminum facing has strong capacity to resist heat radiation and is an excellent material for the inner lining for high temperature workshops, control rooms, inner wall, compartments and ceiling of equipment rooms.



ROCKWOOL

Rockwool provides protection against fire, heat, cold and noise for the building, process, marine and offshore industries. The great advantage of Rock wool products is that thermal insulation can be combined with excellent noise reduction capabilities and high mechanical strength. Adding to this provides the best guarantee for effective fire protection and water repellent properties.

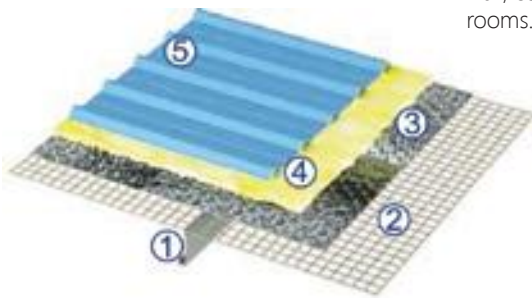

- ① Purlin
- ② Galvanized wire mesh
- ③ Aluminum
- ④ Fiber glass
- ⑤ Roof panel

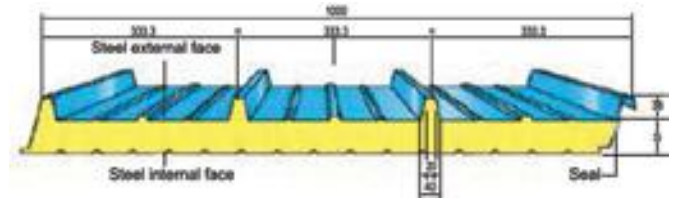

PU

Polyurethane is a energy-saving insulation materials, Light weight and hardness. It can be easily attached to almost all types of paper, plywood, steel plate, aluminum, concrete, tiles, etc. Our rigid PU insulated panels is widely used in the thermal insulation on walls and internal rooms of buildings, and used in thermal insulation of doors, cold storage, refrigerator and so on. The surface layer of two sides of the panels could be embossed aluminum foil,kraft paper, color tin or nothing.

SANDWICH

Sandwich insulation panels are widely used in the thermal insulation on wall and roof of building, and construction of refrigeration and freeze, doors and windows of building, industrial instrument and special vehicles, etc.

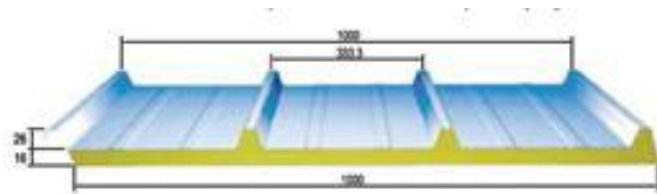

Reflectivity and Emissivity Coefficient			
No	Material Surface	Reflectivity Coefficient R	Emissivity Coefficient E
1	Silver foil	98%	2%
2	Aluminum foil	97%	3%
3	Glass wool	25%	75%
4	Zincalume sheeting	80%	20%
5	Galvanized sheeting (new)	72%	28%
6	Galvanized sheeting (old)	12%	88%
7	Alkyd paint (average of 16 colors)	4% -> 8%	92% -> 96%
8	Concrete	10%	90%
9	Mortar	13%	87%
10	Wood	9%	91%

The higher of R coefficient, the better for insulating

Thermal Conductivity Coefficient K		
No	Material	Thermal conductivity Coefficient K W/m. ² K @ 25 °C
1	Air	0,024
2	Glass wool	0,037
3	Rock wool	0,034
4	Polyurethane (PU)	0,026
5	Sandwich Panel	0,038
6	(Expanded Polystyrene EPS)	50,2
7	Sheeting	0,80 (0,38)
8	Concrete (lightweight)	0,12

The lower of K coefficient, the better for insulating

Panel profiles

ROOF PANEL: Zinc - Alumne alloy coated sheet, which has superior corrosion resistance and long life.

WALL PANEL: Pre-painted Zinc - Alumne alloy coated steel sheet, which is not only good corrosion resistance but also good decoration as well.

5 RIBS PROFILE

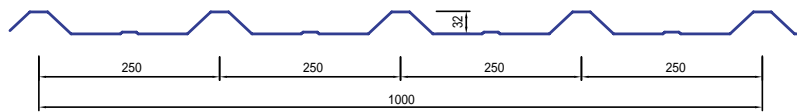

Advantages: Being one of the most popular profile; Easy to install; High ribs; Suitable for roofing, Strong wind areas; Low slope up to 10%.

7 RIBS PROFILE

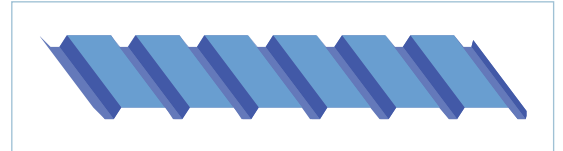
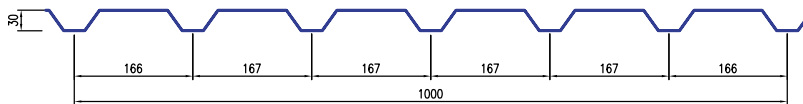

Advantages: It is Excellent for decoration; Easy to install; Suitable for walling.

CLIP LOCK

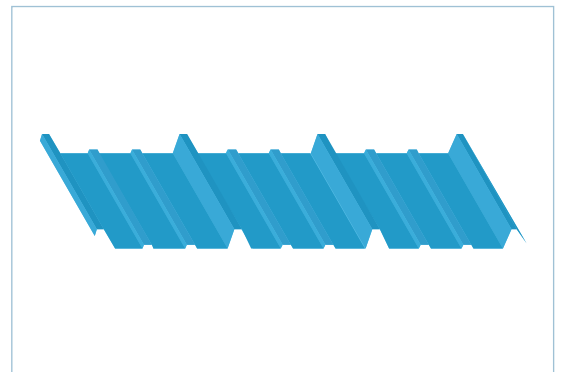
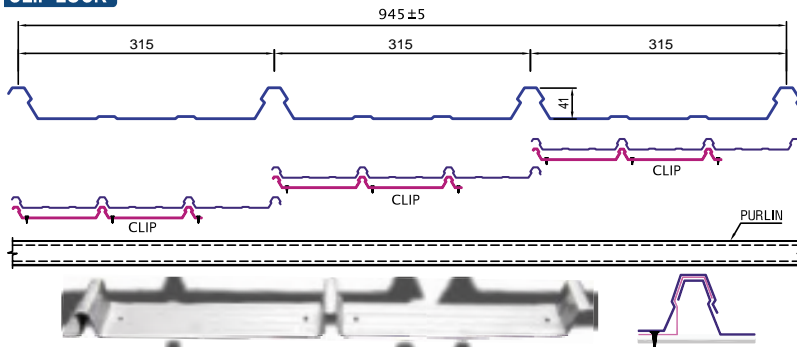

Advantages: Good Leaking prevention; modernity; Suitable for roofing, strong wind areas; Low slope up to 6%.

SEAM - PLUS

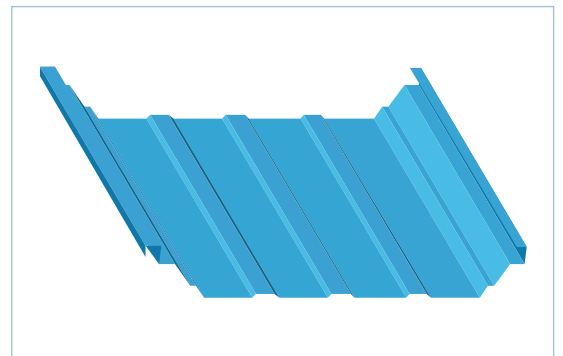
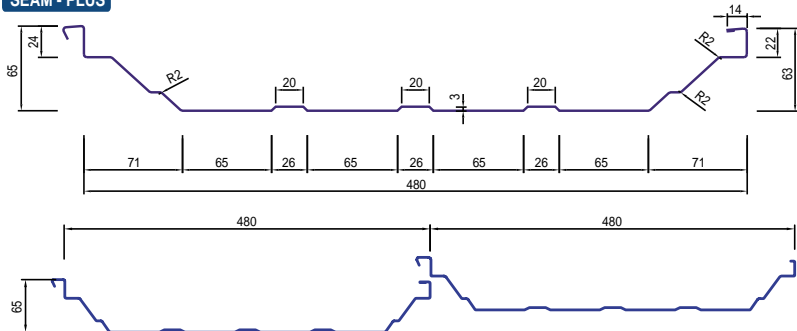

Advantages: Withstanding strong Wind Uplift; Excellent appearance and modernity; Great Reliability; Long life; Without having any end laps; Totally Leaking prevention; Low slope up to 3%.

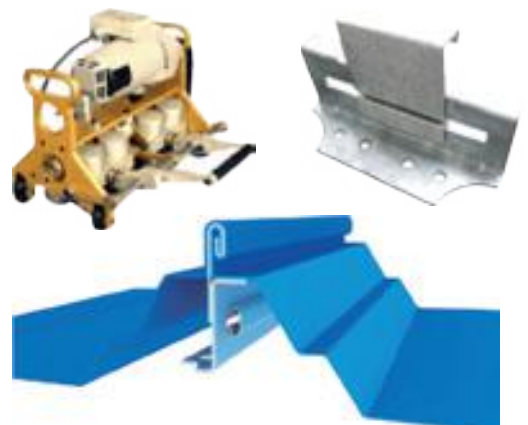
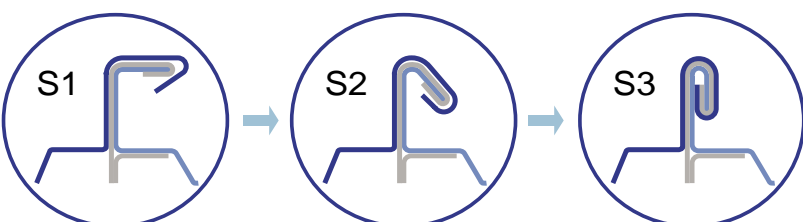

Decking

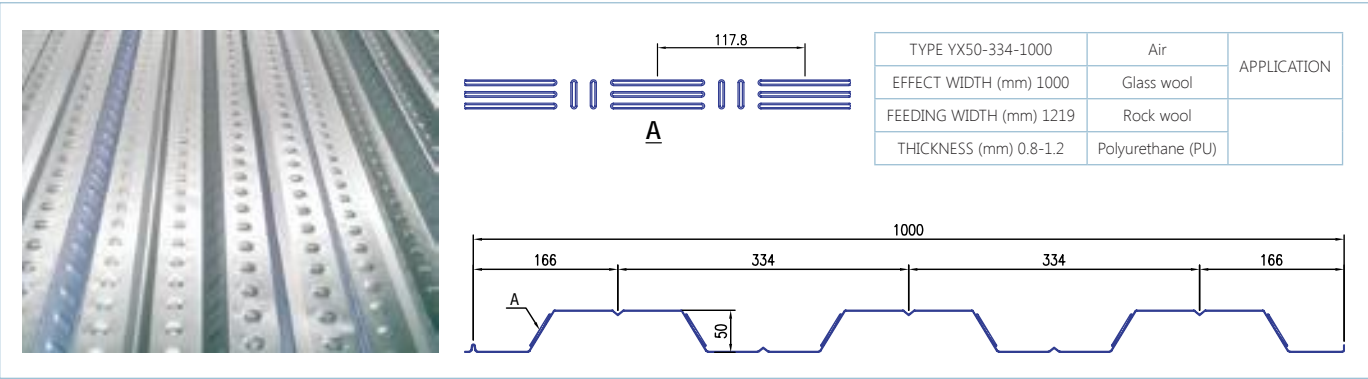
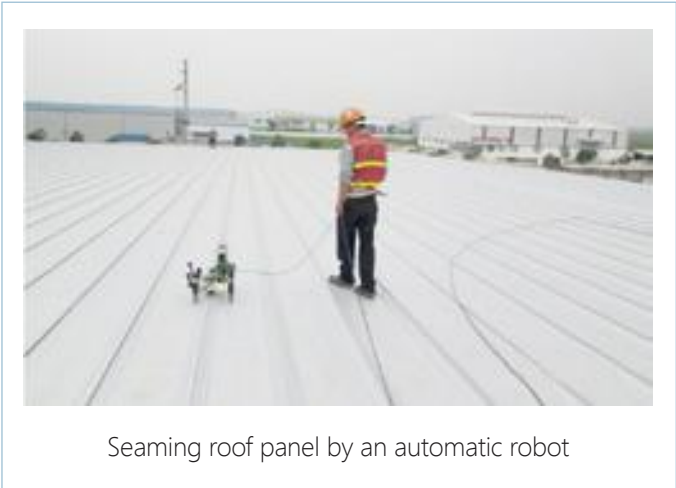

Standard panel color

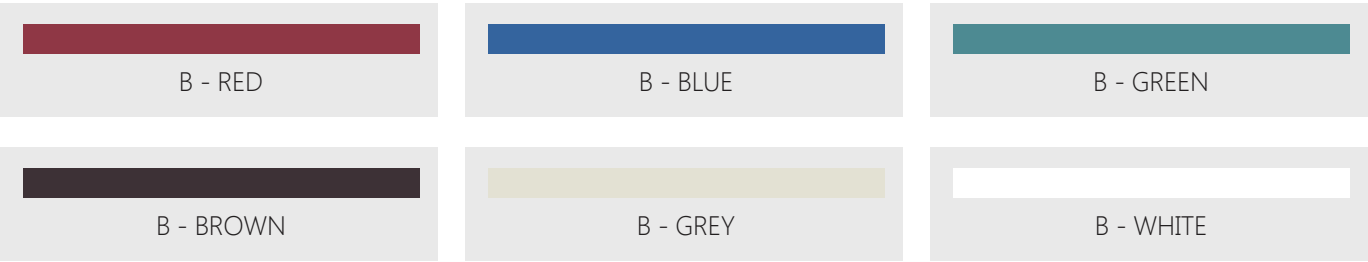

Sundry items



Typical projects

SHENZHOU GROUP

1 Gain Lucky

Area: 600.000 sq meters

Location: Phuoc Dong IP - Go Dau - Tay Ninh

2 Worldon

Project type: Textile & Garment, Dyeing factories

Area: 250.000 sq meters

Location: Dong Nam IP - Cu Chi - HCMC

3 Marvel

Area: 400.000 sq meters

Location: Cambodia





NOKIA

Project type: Factory

Area: 75.000 sq meters

Location: Bac Ninh IP - Ha Noi



DUY TAN PLASTIC

Area: 180.000 sq meters

Location: Tan Do IP - Long An - Viet Nam

Phase 1

Project type: Warehouse

Area: 30.000 sq meters



BETAGRO

Project type: Feed Mill & Warehouse, Rack

Area: 45.000 sq meters

Steel tonage: 3.000 tons of steel



UNI PRESIDENT

Project type: Feed Mill

Steel tonage: 1.200 tons of steel

Location: Tien Giang IP - Viet Nam





KHON KEAN NEW WAREHOUSE

Owner: Charoen Pokphand Group

Location: Thailand



CARGILL 1

Project type: Feed Mill

Steel tonnage: 1.000 tons of steel

Location: Dong Van IP - Ha Nam



CARGILL 2

Steel tonnage: 1.100 tons of steel

Location: Binh Duong - Vietnam



VINAMILK

Project type: Cow Farm

Area: 40.000 sq meters

Location: Thanh Hoa - Viet Nam



ROYAL FOOD

Project type: Sea Food Processing Factory

Area: 30.000 sq meters

Location: Nghe An - Viet Nam



KINH DO

Project type: Bakery Factory

Area: 80.000 sq meters

Location: VSIP - Binh Duong



TANCHONG GROUP

Project type: NISSAN Car Assembly

Area: 60.000 sq meters

Location: Da Nang



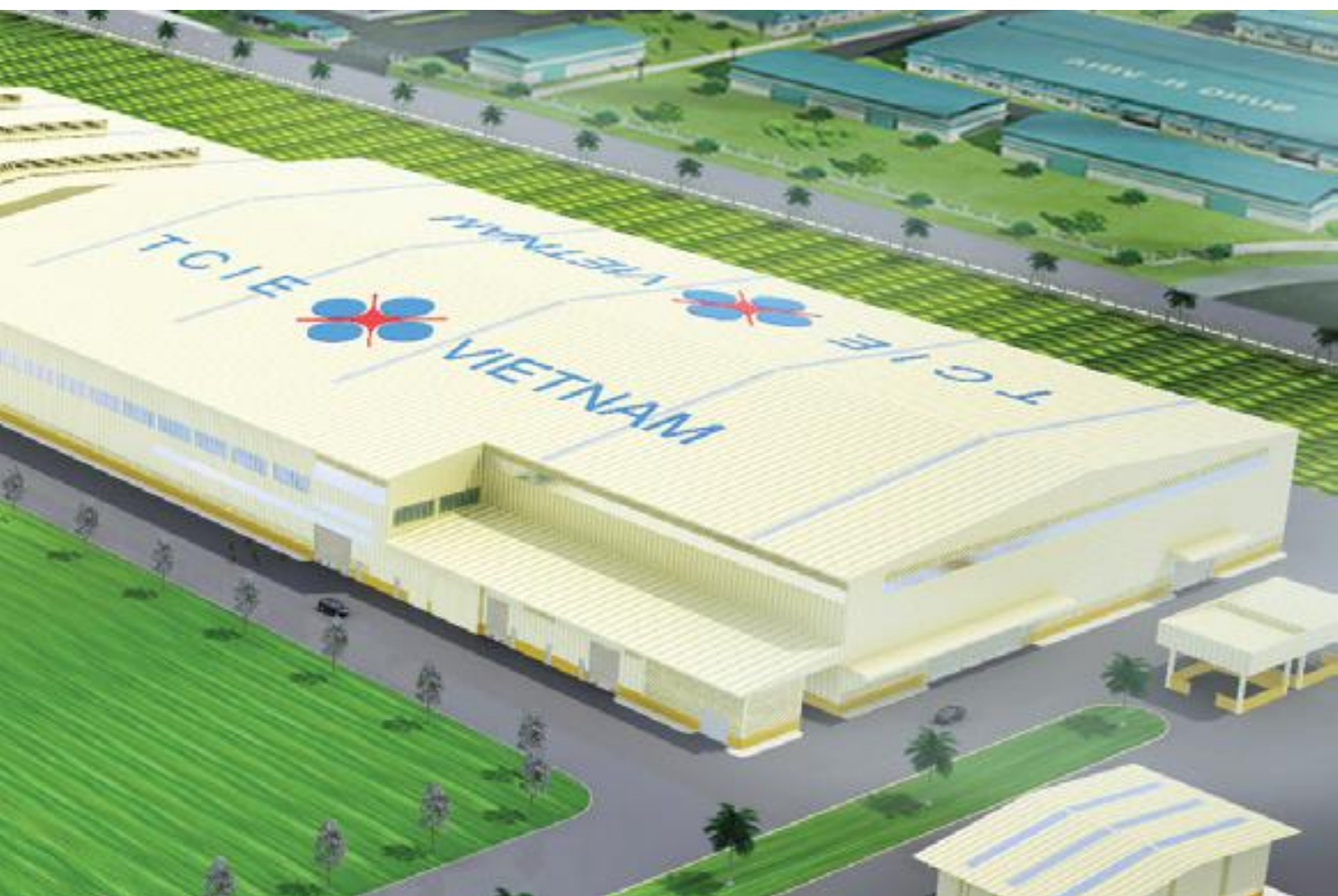

KERRY WORLD BRIDGE

Area: 30.000 sq meters 60 hecta land

Location: Phnompenh - Cambodia



KERRY LOGISTIC

Area: 15.000 sq meters

Location: Hung Yen - Ha Noi



KERRY LOGISTIC

Area: 50.000 sq meters

Location: Yangon - Myanmar



KERRY LOGISTIC

Area: 25.000 sq meters

Location: Mandalay - Myanmar



CAN THO AIRPORT TERMINAL

Area: 20.000 sq meters

Steel tonnage: 1.500 tons of steel

Location: Mekong Delta - Viet Nam



HYUNDAI SHIPYARD

Phase 1

Project type: Painting Factory

Steel tonnage: 1.500 tons of steel

Project type: Factory

Steel tonnage: 1.000 tons of steel

Phase 2

Project type: Workshop

Steel tonnage: 2.000 tons of steel

Phase 3

Project type: Material Warehouse
& Blasting Shop

Steel tonnage: 1.500 tons of steel



POSCO SS VINA Phraise 1

Project type: Melt shop

Area: 25.000 sq meters

Location: Phu My IP - BRVT



POSCO HGI VINA Phraise 2

Project type: Warehouse

Area: 20.000 sq meters

Location: Phu My IP - BRVT



Japanese projects in Vietnam

INAX

Project type: Sanitary Factory

Area: 24.000 sq meters

Location: Phu My - BRVT



PLUS

Project type: Stationery Factory

Area: 15.000 sq meters

Location: Nhon Trach IP - Dong Nai



KATOLEC

Project type: Factory

Area: 10.000 sq meters

Location: Bac Ninh IP



SUMITOMO

Project type: Cement

Steel tonnage: 800 tons of steel

Location: Dinh Vu IP - Hai Phong



UNIDEN

Project type: Electronic accessory factory

Area: 15.000 sq meters

Location: Tan Truong IP - Hai Duong



TANAKA

Project type: Factory

Area: 10.000 sq meters

Location: Dinh Vu IP - Hai Phong



BRIDGESTONE

Project type: Type Factory

Steel tonnage: 1.500 tons of steel

Location: Dinh Vu IP - Hai Phong



YOKOWO

Phase 1

Area: 10.000 sq meters

Location: Dong Van IP - Ha Nam

Phase 2

Area: 10.000 sq meters

Location: Dong Van IP - Ha Nam



FUJI SEAL

Project type: Factory

Area: 12.000 sq meters

Location: VSIP 2 - Binh Duong



JFE SHOJI

Project type: Steel Workshop

Area: 16.000 sq meters

Location: Dinh Vu IP - HP



PANASONIC

Project type: Extension

Steel tonnage: 500 tons of steel

Location: Thang Long IP - HN



Projects in Vietnam

ORTHOLITE

Area: 80.000 sq meters

Location: Binh Duong



XUAN THANH CEMENT

Project type: Warehouse

Area: 50.000 sq meters

Location: Ha Nam



SIKA FACTORY PROJECT

Area: 18.000 sq meters

Location: Bac Ninh



SIEMENS

Project type: Electric Tools factory

Area: 10.000 sq meters

Location: VSIP - Binh Duong



MASAN

Area: 40.000 sq meters

Steel tonage: 800 tons of steel

Location: Binh Dinh





PROCONCO
BÌNH ĐỊNH



SAMSUNG

Project type: Electronic factory
Steel tonnage: 2200 tons of steel
Location: Thai Nguyen



JOHNSON CONTROL

Project type: Car component factory
Area: 12.000 sq meters
Location: VSIP - Binh Duong



PAIHO

Area: 30.000 sq meters
Location: Le Minh Xuan3 IP - Binh Chanh



TAN PHUOC KHANH

Project type: Sheeting factory

Area: 20.000 sq meters

Location: Phu My IP – BRVT



VINAMILK

Project type: Coffee Factory

Area: 14.000 sq meters

Location: My Phuoc IP – Binh Duong



DHL

Project type: Logistic office & warehouse

Area: 30.000 sq meters

Location: Tan Son Nhat airport – HCM



ICD - LONG BINH

Project type: Logistic warehouse - 4 buildings

Area: 80.000 sq meters

Location: Long Binh - Dong Nai



ALS

Project type: Logistic Warehouse

Steel tonnage: 3.000 tons of steel

Location: Noi Bai - Ha Noi



NEUMAN GROUP

Project type: Coffee factory

Area: 30.000 sq meters

Location: Long Duc IP - Dong Nai



KEPPEL ITL

Project type: Logistic warehouse

Area: 15.000 sq meters

Location: VSIP 1 - Binh Duong



VIKID

Project type: Kid center

Area: 12.000 sq meters

Location: HCM



CO.OP MART

05 Supermarket shops in HCM, Binh Duong, Pleiku



THACO GROUP

KIA showroom - HCM



LEXUS SHOWROOM

Showroom - District 1 - HCM



DONG A LAND MODEL HOUSE

Location: HCM city



ONEHUB SAIGON

Steel tonnage: 200 tons of steel

Location: District 9 - HCMC





RALS INTERNATIONAL

Project type: Cashew Nut factory

Area: 25.000 sq meters

Location: Long An



INTERFLOUR

Project type: Flour Mill

Steel tonnage: 1.500 tons of steel

Location: Phu My IP - BRVT





HENIKEN (VBL)

Project type: Beer factory

Area: 10.000 sq meters

Location: Tien Giang IP

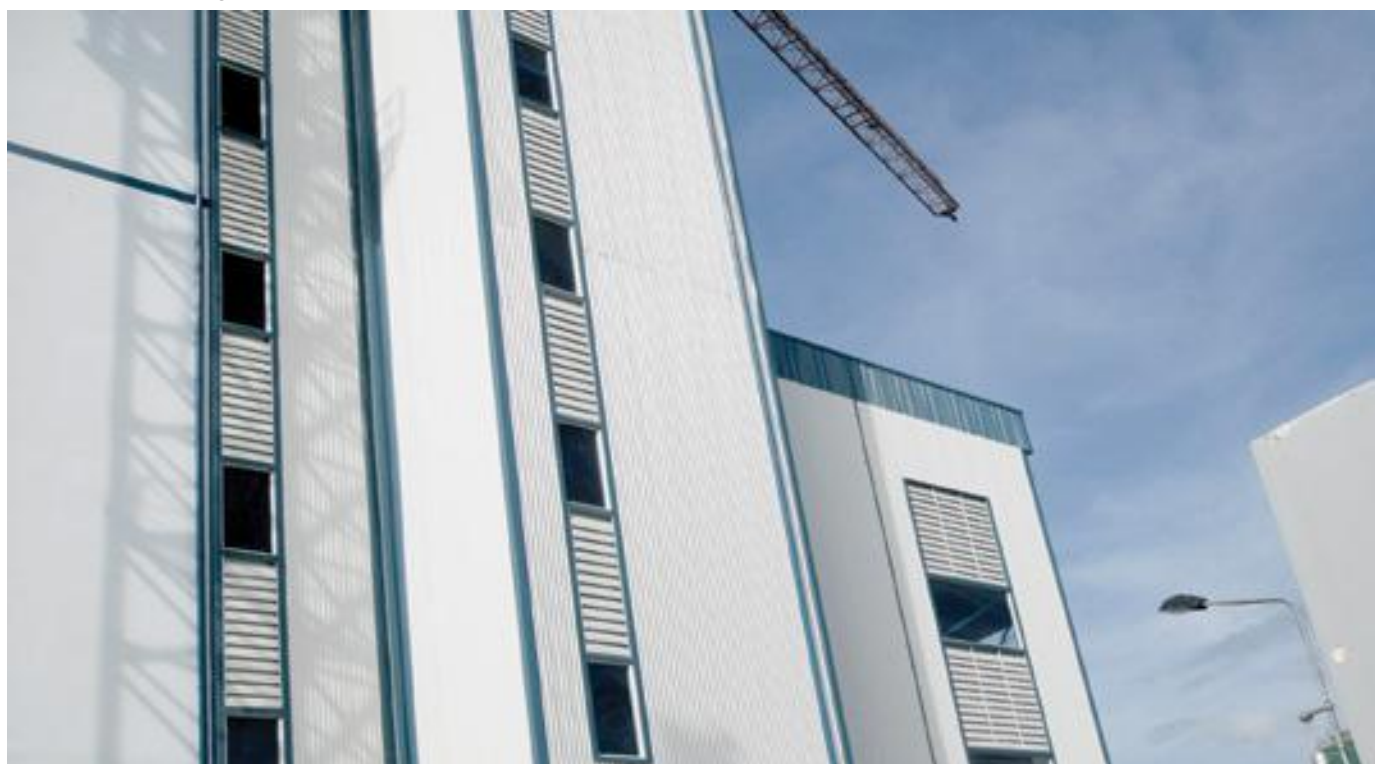

DAT HOA PLASTIC

Project type: PVC & HDPE factory

Area: 40.000 sq meters

Location: My Phuoc IP - Binh Duong



SUPOR

Project type: Cookware factory

Area: 20.000 sq meters

Location: My Phuoc IP - Binh Duong





ANTARA

Project type: COLD Storage

Area: 15.000 sq meters

Location: HCM



HUNG VUONG GROUP

Project type: Cold storage

Area: 20.000 sq meters

Location: Tan Tao IP - HCM



TNG GROUP

Project type: Garment factory

Area: 30.000 sq meters

Location: Phu Binh - Thai Nguyen



TWINKLE

Project type: TUMI garment factory

Area: 25.000 sq meters

Location: My Xuan IP - BRVT



CORONET

Project type: Shoe factory

Area: 15.000 sq meters

Location: Giao Long IP - Ben Tre



NPK

Project type: Fertilizer warehouse

Area: 6.000 sq meters

Location: Go Dau IP - BRVT



SCG GROUP

Project type: Vina Kraft paper factory

Area: 18.000 sq meters

Location: My Phuoc IP - Binh Duong



SOVI

Project type: Paper Packaging factory

Area: 30.000 sq meters

Location: My Phuoc IP - Binh Duong



FALCON

Project type: Furniture factory

Area: 20.000 sq meters

Location: Dai An IP - Hai Duong



PHUONG HOANG XANH

Project type: Artificial Stone Factory

Area: 30.000 sq meters

Location: Ha Noi



BA HUAN

Project type: Egg factory

Area: 20.000 sq meters

Location: Le Minh Xuan IP - Long An



TEXHONG FACTORY

Project type: Factory

Area: 60.000 sq meters

Location: Quang Ninh



Projects in Myanmar

ISUZU WAREHOUSE

Project type: Warehouse
Area: 10.000 sq meters
Location: Mingalardon IP- Yangon



AKTIO FACTORY

Project type: Factory
Area: 10.000 sq meters
Location: Thilawa SEZ - Yangon



MDG WAREHOUSE

Area: 15.000 sq meters
Location: Mingaladon



YUSEN LOGISTIC

Area: 15.000 sq meters

Location: Thilawa SEZ - Yangon



YANMAR MYANMAR

Area: 12.000 sq meters

Location: Thilawa SEZ - Yangon



PYN - LANDMARK

Steel tonnage: 2500 tons of steel

Location: Bogyoke Aung San Road - Yangon





URC BISCUITFACTORY

Project type: Factory

Area: 32.000 sq meters

Location: Mingaladon IP



FOSTER (JAPAN)

Phase 1

Area: 16.000 sq meters

Location: Thilawa IP

Phase 2

Area: 32.000 sq meters

Location: Thilawa IP





CP GROUP

Project type: Feed Mill & warehouse

Area: 20.000 sq meters

Location: Yangon



SHOWA GLOVES

Area: 18.000 sq meters

Location: Thilawa IP



OJI GS PAPER

Area: 16.000 sq meters

Location: Mingaladon IP - Yangon



KONOIKE TRANSPORTATION

Area: 7.000 sq meters

Location: Thilawa SEZ - Yangon



KOYORAD

Area: 8.000 sq meters

Location: Thilawa IP



HONEY GARMENT

Area: 24.000 sq meters

Location: Mingaladon IP - Yangon



MARUBENI FERTILIZER

Area: 15.000 sq meters

Location: Thilawa SEZ - Yangon



RK STEEL FACTORY

Area: 20.000 sq meters

Location: Thilawa SEZ - Yangon



ACECOOK PROJECT

Area: 30.000 sq meters

Location: Thilawa SEZ - Yangon



RICHEST TIME FACTORY

Area: 20.000 sq meters

Location: Mingalardon IP - Yangon



PATHEIN HOSPITAL

Area: 30.000 sq meters

Steel tonnage: 4000 tons of steel

Location: Patheingyi City



CPP FERTILIZER FACTORY

Project type: Factory

Area: 20.000 sq meters

Location: Thilawa SEZ - Yangon



PCG PROJECT

Area: 30.000 sq meters

Steel tonnage: 2.000 tons of steel

Location: Bago IP



OSOTSPA

Area: 40.000 sq meters

Steel tonage: 4.000 tons of steel

Location: Thilawa - Yangon



SUPER HOTEL PROJECT

Area: 7.000 sq meters

Location: Thilawa SEZ - Yangon - Myanmar



AJU PHC - PILE PLANT PROJECT

Project type: Factory

Area: 7.000 sq meters

Location: Thilawa SEZ - Yangon - Myanmar



Projects in Thailand

BORG WARNER

Project type: Factory & Office

Area: 8.000 sq meters

Location: Chonburi



NEW CS

Steel tonnage: 700 tons of steel

Location: Lopburi



VITALO

Area: 8.000 sq meters

Location: Prachinburi



SEAGATE

Project type: Mainboard computer factory - Phase 6

Steel tonnage: 350 tons of steel

Location: Thailand



TOPRE

Toyota Car Component

Area: 50.000 sq meters

Location: Asia IP - Latkrabang



PANJAPHOL PROJECT

Area: 13.000 sq meters

Steel tonnage: 670 tons of steel

Location: Samutsakorn



NEW CS

Area: 50.000 sq meters

Location: Lopburi



Projects type in Cambodia

GOLDEN RICE MILL

Area: 35.000 sq meters

Location: Battambang



SIX PLUS

Project type: Garment Factory

Area: 12.000 sq meters

Location: Kandal



LE URBAN (SINGAPORE)

Project type: Garment factory

Area: 15.000 sq meters

Location: Phnompenh



CAMBREW

Project type: Office & Warehouse

Area: 16.000 sq meters

Location: Phnompenh



CROWN

Tin Plate can factory

Steel tonnage: 500 tons of steel

Location: Shihanoukville



DON BOSCO

Sisters School

Area: 6.000 sq meters

Location: Phnompenh



LYP GROUP

KKN Apparel Factory: 30.000 sq meters

Phase 1 - 28.000 sq meters

Phase 2 - 30.000 sq meters



PRIMALIS

Project type: Rice Mill
Area: 50.000 sq meters
Location: Phnompenh



LONG GRAIN

Project type: Rice Mill
Area: 10.000 sq meters
Location: Cambodia





LUCKY MARKET

Project type: Distribution center

Area: 12,000 sq meters

Location: Phnompenh



MONG RETHTHY GROUP

Project type: Brick factory

Area: 30.000 sq meters

Location: Sihanoukville



SIEM REAP AIRPORT TERMINAL

Project type: Extension

Area: 5.000 sq meters

Location: Siem Reap





CHUAN HUAT

Project type: Steel Welding Mesh factory

Area: 10.000 sq meters

Location: EPZ - Phnompenh



MAKRO SIEM REAP PROJECT

Project type: Factory

Area: 20.000 sq meters

Location: Cambodia



KINGMAKER

Project type: Garment factory

Area: 16.000 sq meters

Location: Mahatan IP - Bavet



NORTH BRIDGE SCHOOL

Steel tonnage: 500 tons of steel

Location: Phnompenh



SWANTY

Project type: Garment factory

Location: Taiseng IP - Bavet



Projects in Singapore, Australia & Indonesia

UTRACO

Project type: Shipyard

Steel tonnage: 1.000 tons of steel

Location: Batam - Indonesia



PUNGGOL DEPOT

Project type: Warehouse

Area: 5.000 sq meters

Location: Singapore



SIKA

Steel tonnage: 300 tons of steel

Location: Australia



SAMSUNG

Project type: The extension

Steel tonnage: 350 tons of steel

Location: Australia



Projects in Philippines

KNAUF GYPSUM PHILIPPINES

Project type: Manufacturing Plant

Area: 40.000 sq meters

Location: Calaca, Batangas



CHAROEN POKPHAND FOODS (CPF) PHILIPPINES

Project type: Feedmill

Area: 6.000 sq meters

Location: Gerona, Tarlac



UNIVERSAL ROBINA CORPORATION (URC)

Project type: Warehouse and Plant

Area: 10.000 sq meters

Location: San Pedro, Laguna



GARDENIA

Project type: Bakery Plant

Steel tonnage: 500 tons of steel

Location: Binan, Laguna



WILCON DEPOT ZAMBOANGA

Project type: Commercial Building

Area: 10.000 sq meters

Location: Zamboanga



WILCON DEPOT ZAMBOANGA

Project type: Commercial Building

Area: 10.000 sq meters

Location: Zamboanga



CABUYAO MULTI PURPOSE HALL

Project type: Commercial Building

Steel tonnage: 700 tons of steel

Location: Cabuyao - Laguna



MEDCOR HOSPITAL

Steel tonage: 700 tons of steel



SPWS Phase 6

Area: 8.000 sq meters



UNILAP

Area: 13.000 sq meters



Projects with repeated customers

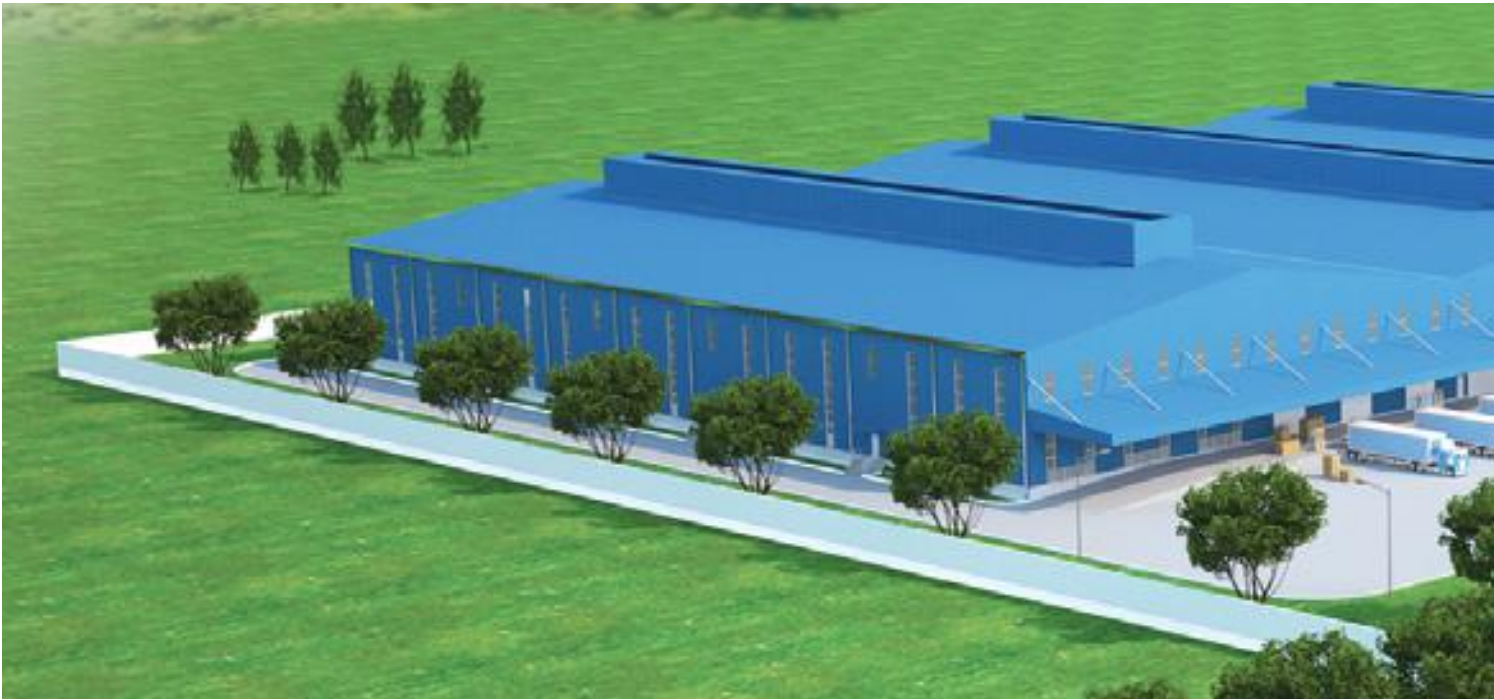

LOCK & LOCK GLASS

Phase1

Cookware - Phu My IP - 30.000 sq meters

Phase2

Phu My IP - 60.000 sq meters

Phase 3

Phu My IP - 30.000 sq meters

Phase 4

Warehouse - 20.000 sq meters - Phu My IP - BRVT

Phase 5

Distribution center - MM 2000 IP - Jakarta - Indonesia

Phase 6

Distribution center - 30.000 sq meters - Long Hau IP - HCM







PEPSICO

Pepsico Can Tho

1st project - 30.000 sq meters

Pepsico Bac Ninh

2nd project - 45.000 sq meters - VSIP Bac Ninh

Pepsico Extension

8.000 sq meters - VSIP Bac Ninh

Pepsico 3rd

Factory - 20.000 sq meters & pipe rack - Amata IP - Dong Nai





1 OJI TEX

1st project

Area: 30.000 sq meters

Location: VSIP Bac Ninh

2 OJI HARTA

2nd project

Area: 18.000 sq meters

Location: Sihanoukville IP -

Cambodia

3 OJITEX MINGALADON

Area: 20.000 sq meters

Location: Mingaladon IP -

Yangon - Myanmar

4 OJITEX PPSEZ

Area: 30.000 sq meters

Location: Phnompenh -

Cambodia





SSY SHIPYARD

Phase 1

Body Shop -30.000 sq meters - HCM

Phase 1

Erection - Crane 80 tons of steel - HCM

Phase 2

15.000 sq meters - Warehouse - HCM

Phase 3

18.000 sq meters - Workshop - Long Xuyen IP - BRVT

Phase 4

10.000 sq meters - Facility Building - Long Xuyen IP - BRVT

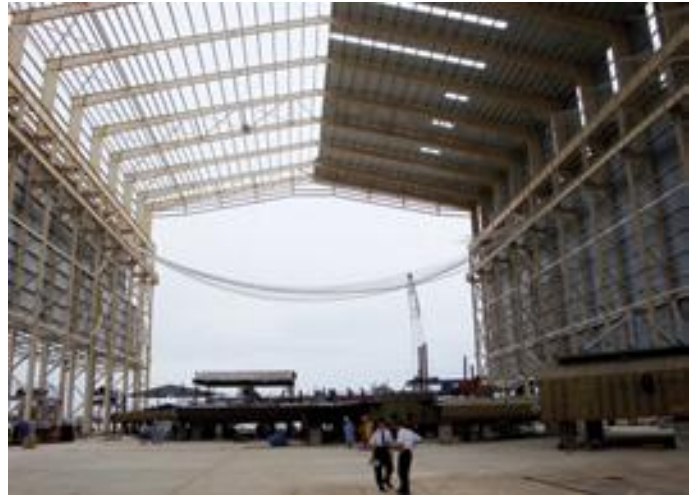



LS CABLE

Phase 1

20.000 sq meters - Nhon Trach IP - Dong Nai

Phase 2

12.000 sq meters & Pipe rack - Nhon Trach IP - Dong Nai

Phase 3

15.000 sq meters - Nhon Trach IP - Dong Nai

Phase 4

10.000 sq meters - Nhon Trach IP - Dong Nai



Contractors & Customers

We would like to express our deep thanks to all our partners for giving BMB Steel the opportunities to cooperate and develop.

The Contractor

The Client

Testimonials





Social activities

BMB charity lunch house is serving 500 free meals per day, and we endeavour to reach one million meals each year.





Factories

Factory 1

Capacity 2.500 MT/month
Nam Tan Uyen, Binh Duong, Viet Nam

Factory 2

Capacity 750 MT/month
My Hao, Hung Yen, Viet Nam

Factory 3

Capacity 1.000 MT/month
Binh Duong - Viet Nam

Factory 4

Capacity 750 MT/month
Nam Tan Uyen, Binh Duong, Viet Nam

Viet Nam office



Head Office

148 Phan Xich Long St., Ward 7, Phu Nhuan
Dist., HCMC - Viet Nam
(+84-28) 35 172 509/11 - 35 127 601
www.bmbsteel.com.vn



Ha Noi Office

Floor 1, 18T2 Le Van Luong, 76 Nguyen Thi
Dinh St., Tan Chinh, Thanh Xuan, Hanoi
(+84-24) 39 412 176/77



Da Nang Office

Studio 303, floor 3, Enouvo space
co-working-co-living building, 16 An Nhon 3,
An Hai Bac, Son Tra, Da Nang
(+84-28) 3 5172 509

Oversea Office



Myanmar Office

No37/C, Thirimingalar Street, Kamayut
township, Yangon, Myanmar



Cambodia Office

G16 Golden Street, City 307-309, Street
271, Turnup Toek quater, Chamkar mon
Dist, Phnom Penh
(+855) 23 21 54 03/04

Philippines Office



Manila Office

14th Floor, Unit 1415, A/C Burgundy Empire
Tower, ADB Avenue Corner, Gamet Road,
Ortigas Center, Pasig City, Philippines
(+632) 470 7633/33/34



Cebu Office

1508 Park Centrale, Jose Maria del Mar St,
Cebu IT Park, Apas, Cebu City 6000
(+63-32)-266-9398



Indonesia Office

Alamanda Tower Lantai 31 Unit E, Jalan TB
Simatupang Kav. 23 - 24 Cilindak Barat,
Jakarta Selatan 12430



Thailand Office

54 Sukhumvit Road (Asoke), North Klongtoey,
Watthana, Bangkok 10110
(+66) 2664 4493



Version	
Revision No	BMB-08
Revision Date	07.2019

www.bmbsteel.com.vn